



SUVAN
FORETT 
RECONNECTING WITH SERENITY
2 BHK OPTIMUM HOMES



SUVAN FORETT

RECONNECTING WITH SERENITY
2 BHK OPTIMUM HOMES

*I*magine living in the luxury of nature surrounded by green forest.

Suvan Forett - an idyllic location for the growing family - Cuddled up in the backdrop of a hill, overlooking the Pune - Bangalore Highway and surrounded by beautiful views of a forest and a colossal playground, is an exclusive new development located on south - western corridor of Pune.

Suvan Forett is a development designed with quality urban forms and spaces to meet the current urban design standards, which enhances and successfully integrates the development into its scenic surroundings.



BUILDING AMENITIES

- Excellent State of Art Elevation
- Attractive Entrance
- All Flats Shall Be “Living Terrace” Flats
- Dry Balcony For Flats
- Gas Pipeline Provision For Kitchens
- Rain Water Harvesting
- Vermiculture System
- Fire Fighting System
- Two Lifts With Backup
- Intercom Facility

SPECIFICATIONS

- R.C.C. Framed Structure With Seismic Resistant Design
- Concealed Wiring And Plumbing
- T.V. & Telephone Points In Living & Master Bed
- Standard Make Fittings And Sanitary Ware In All Bathrooms
- Vitrified Flooring In All Rooms
- Anti-skid Tiles, Dado Upto Lintel Level In Toilets And Bathrooms
- Anti-skid Tiles In Terrace
- Black Granite Kitchen Platform With SS Sink
- Dado Upto Lintel Level Above Kitchen Platform
- Internal Wall : Oil Bound Distemper Paint
- External Wall : Cement Paint
- Powder Coated Aluminium Sliding Windows
- Louvered Windows To Toilets And Bathrooms
- MS Safety Grills To All Windows
- Flush Doors With Plywood Frames To All Rooms
- Aluminum Sliding Door To Living Rooms Terrace

TYPICAL 2 BHKD LAYOUT





CREDITS

ARCHITECT
Shinde Joshi Associates

PLUMBING CONSULTANT
Unity Consultants Pvt. Ltd.

ELECTRICAL CONSULTANT
Federal Engineering Works

R.C.C. CONSULTANT
R.K. Randhave Consultants

LEGAL ADVISORS
Adv. Pradeep Khire

A PROJECT BY
L. M. BAFNA

Site : Suvan Forett, S. No. 114/1, Plot No. 2, Behind Soba Puram, Opp. Sinhagad School, Warje 411058.

The contents of this brochure are only indicate & purely conceptual and have no legal binding on us. The developer reserves th rights to amend the layout, number of floors, number of flats, elevation, colour scheme, specifications, amenities, furniture layout, etc. The printed matenal does not constitute a contract/offer on any type between the developer & recipient.

ODD FLOOR PLAN

AREA STATEMENT (SQ.FT.)

FLAT NO.	CARPET	TERRACE	SALEABLE
101,301,501 701,901	734.00	148.00	1147.00
102,302,502 702,902	734.00	145.00	1143.00
103,303,503 703,903	721.00	141.00	1121.00
104,304,504 704,904	721.00	130.00	1106.00

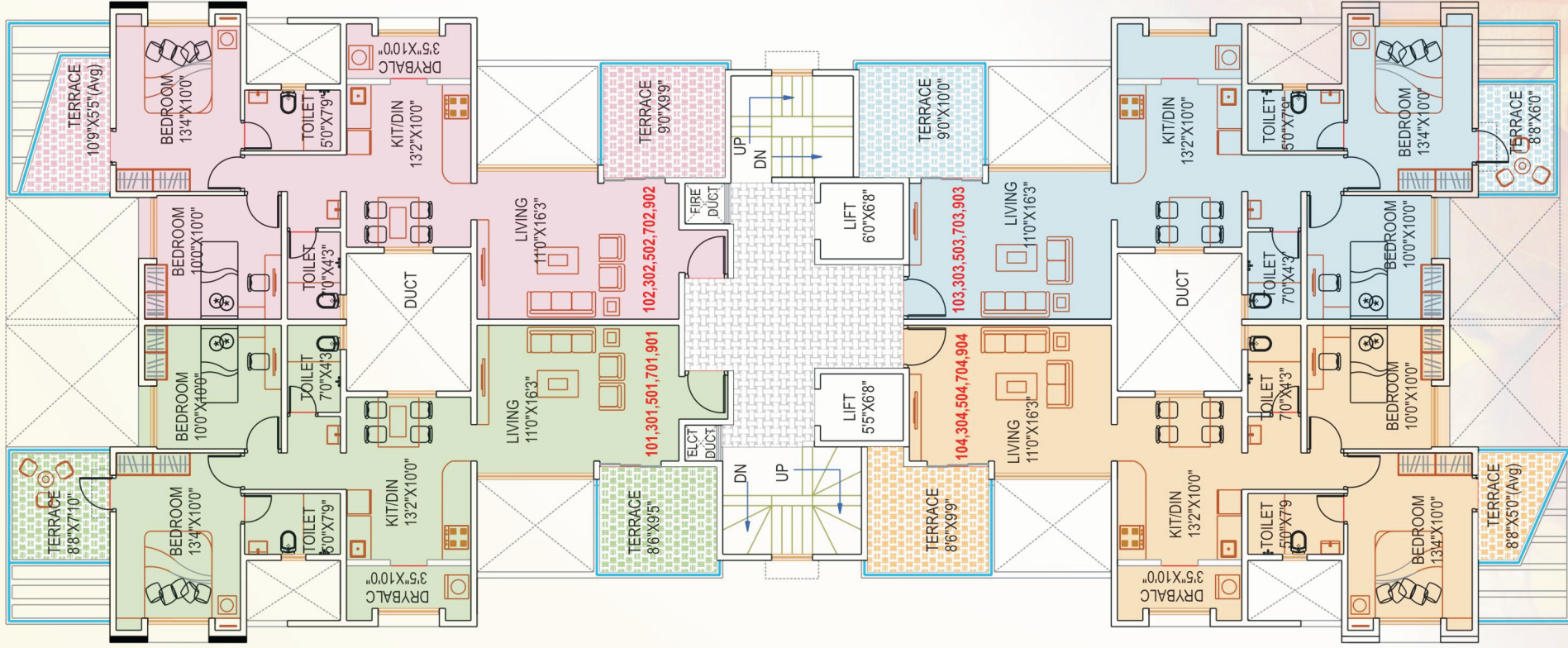

EVEN FLOOR PLAN

AREA STATEMENT (SQ.FT.)

FLAT NO.	CARPET	TERRACE	SALEABLE
201,401 601	727.00	189.00	1191.00
202,402 602,802	727.00	197.00	1201.00
203,403 603,803	713.00	181.00	1162.00
204,404, 604,804	713.00	172.00	1151.00

